

APC BUTTON .af

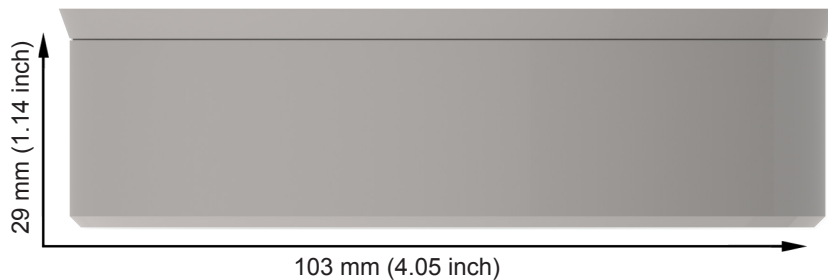

ACTUAL SIZE IMAGES

Usage examples

The APC Button af is a small, robust and high performance 2.4 GHz indoor access point designed for SOHO and small to medium size enterprise applications. Unobtrusive design and operational robustness make it ideal for permanent installations on high walls or ceilings.

This product is equipped with a high output power (up to 23 dBm) 802.11n MIMO radio which allows effective communication with older 802.11b/g equipment as well as newer standards based devices.

Dual firmware image will allow safe software upgrades. The device will restart using the prior working firmware in the unfortunate event of an upgrade failure.

802.3af standard support allows powering the device with PoE switches and makes installation easy by running a single cable from a switch.

The APC Button uses an advanced and feature-rich operating system which supports bridge/router and repeater modes (repeater mode allows the product to operate as an access point and as a station at the same time). It also provides a user-friendly Adobe Flex based GUI with instant reconfiguration (without a reboot), installation tools (site survey, delayed reboot, spectrum analyzer, ping, traceroute) and is compatible with our standalone and cloud based Wireless Network Management System (WNMS).



Small/Medium size office

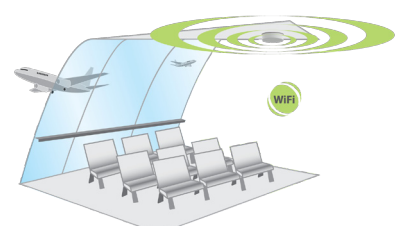

Airport



School/University



Restaurant/Bar

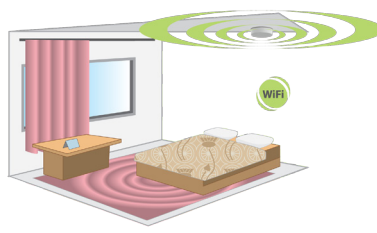

Hotel

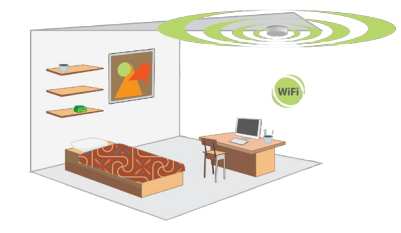

Home

Wireless

| | |
|----------------------|---|
| WLAN standard | IEEE 802.11 b/g/n |
| Radio mode | MIMO 2x2 |
| Operating modes | Access point (auto WDS), Station, Station WDS, Repeater |
| Radio frequency band | 2.402 - 2.484 GHz |
| Transmit power | Up to 23 dBm (country dependent) |
| Receive sensitivity | Varying between -94 and -74 dBm depending on modulation |
| Channel size | 20, 40 MHz |
| Modulation schemes | 802.11 g/n: OFDM (64-QAM, 16-QAM, QPSK, BPSK) 802.11 b: DSS (CCK, DQPSK, DBPSK) |
| Data rates | 802.11 n: 300, 270, 240, 180, 120, 90, 60, 30 Mbps 802.11 g: 54, 48, 36, 24, 18, 12, 9, 6 Mbps 802.11 b: 11, 5.5, 2, 1 Mbps |
| Error correction | FEC, Selective ARQ |
| Duplexing scheme | Time division duplex |

| Receive sensitivity (dBm) | 802.11 N | 15 Mbps | 30 Mbps | 45 Mbps | 60 Mbps | 90 Mbps | 120 Mbps | 135 Mbps | 150 Mbps |
|---------------------------|----------|---------|---------|---------|----------|----------|----------|----------|----------|
| | | -94 | -92 | -89 | -86 | -83 | -78 | -76 | -74 |
| | | 30 Mbps | 60 Mbps | 90 Mbps | 120 Mbps | 180 Mbps | 240 Mbps | 270 Mbps | 300 Mbps |
| | | -94 | -92 | -89 | -86 | -83 | -78 | -76 | -74 |
| | 802.11g | 6 Mbps | 9 Mbps | 12 Mbps | 18 Mbps | 24 Mbps | 36 Mbps | 48 Mbps | 54 Mbps |
| | | -94 | -93 | -92 | -90 | -87 | -84 | -79 | -77 |

| Output power (dBm - combined) | 802.11 N | 15 Mbps | 30 Mbps | 45 Mbps | 60 Mbps | 90 Mbps | 120 Mbps | 135 Mbps | 150 Mbps |
|-------------------------------|----------|---------|---------|---------|----------|----------|----------|----------|----------|
| | | 23 | 23 | 22 | 22 | 20 | 20 | 17 | 17 |
| | | 30 Mbps | 60 Mbps | 90 Mbps | 120 Mbps | 180 Mbps | 240 Mbps | 270 Mbps | 300 Mbps |
| | | 23 | 23 | 22 | 22 | 20 | 20 | 17 | 17 |
| | 802.11g | 6 Mbps | 9 Mbps | 12 Mbps | 18 Mbps | 24 Mbps | 36 Mbps | 48 Mbps | 54 Mbps |
| | | 23 | 23 | 22 | 22 | 21 | 21 | 19 | 18 |

Antenna

| | |
|------|---------------------------------------|
| Type | 2 x internal omni-directional antenna |
| Gain | 3 dBi |

Wired

| | |
|-----------|---------------------|
| Interface | 10/100 Base-T, RJ45 |
|-----------|---------------------|

Networking

| | |
|-------------------|--|
| Operating modes | Bridge, Router |
| WAN | Static IP, DHCP client, PPPoE client |
| NAT | Routing w/ or w/o NAT |
| Static routing | Supported |
| DHCP | Client, Server, Relay |
| Port forwarding | Supported |
| VLAN | Supported for management and data |
| Wireless security | WEP, WPA/WPA2 Personal, WPA/WPA2 Enterprise, WMM, WACL |
| User isolation | Supported |

Software

| | |
|---------------------------------|---|
| General | Ability to define/limit frequency, channel width, EIRP, modulation |
| Advanced wireless functionality | ATPC (automatic transmit power control), auto - channel, auto - modulation |
| Operating mode | Router, bridge |
| Wireless operating modes | AP auto WDS, station, station WDS, virtual radios (VSSID), repeater |
| Wireless security | WPA/WPA2 personal, WPA/WPA2 enterprise, WACL, user isolation, UAM (web portal authentication) |
| Wireless QoS | WMM |
| WAN protocols | Static IP, DHCP client, PPPoE client |
| Network | NAT, static routing, firewall, port forwarding, VLAN, traffic shaping |
| Services | DHCP server, SNMP server, NTP client, Alerts, Remote syslog, Wireless and Ethernet statistics, bandwidth limiting |
| Management | HTTP(S) GUI, SSH CLI, SNMP read, WNMS, troubleshooting file, reset via reset tool |
| Tools | Site survey, link test, ping, traceroute, spectrum analyzer, delayed reboot |

Physical

| | |
|-------------------------|--|
| Dimensions | Length 103 mm (4.05 "), width 103 mm (4.05 "), height 29 mm (1.14 ") |
| Weight | 86 g (3.03 oz) |
| Power supply | Not included in the package |
| Power source | 48 VDC PoE (802.3af), also works with 48 V passive PoE adapters |
| Power consumption (max) | 3.6 W |

Environmental

| | |
|-----------------------|-----------------------------|
| Operating temperature | 0°C (32 F) ~ +55°C (+131 F) |
| Humidity | 0 ~ 90 % (non-condensing) |

Management

| | |
|----------------------|---|
| System configuration | User-friendly web GUI, Command line via SSH, centralized Wireless Network Management System, reset via reset tool |
| System monitoring | SNMP v1/2c/3 server, Syslogs, system alerts via e-mail and SNMP trap |

Regulatory

| | |
|---------------|-------------------------------|
| Certification | FCC/CE/Safety/RoHS compliance |
|---------------|-------------------------------|

LED description:

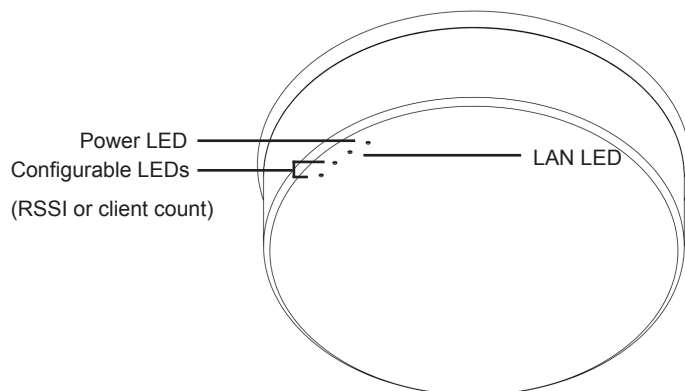

Ceiling/wall mounting scheme:

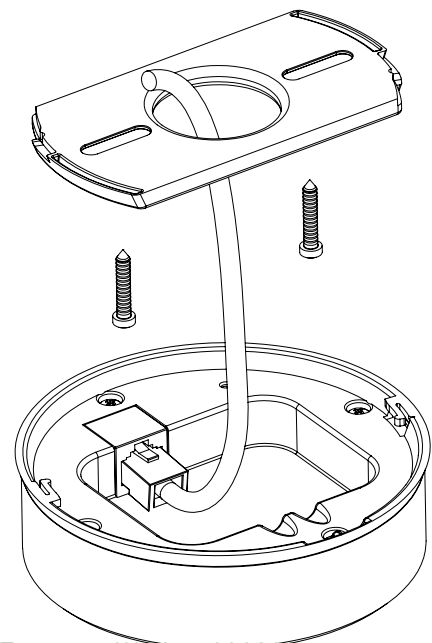



www.deliberant.com